

APPLICATION

Wall mounting

DETAILS

Waterflow around 17l/min
at 3 Bars pressure

Test pressure: 9 Bars/air

Max working pressure: 10 Bars

SURFACE PROTECTION

Epoxy powder coating
RAL 7035

MATERIALS

Brass

Handle in PP

HEADWORK SEALING

EPDM temperature
working range: 0-70°

CERAMIC temperature
working range: 0-70°

CONNECTION TAP

Male thread G1/2"

STANDARD AND NORMS

EN13792:2000

DIN12898

DIN12918

ISO228/1

OPTIONS

Joystick handle 11030.2MDSJ

Ceramic headwork 90°
11030.2MDSC

With chemical nickel
plating 17 microns inside
11030.2MDSNK

Spout:

200 - 250

300 - 350 mm

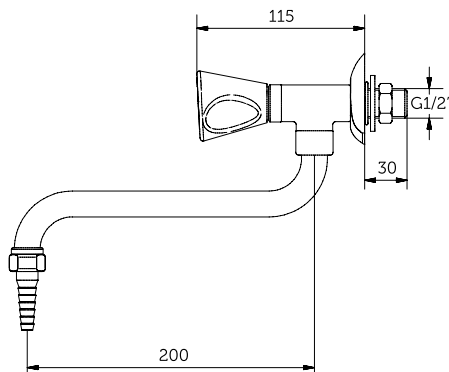
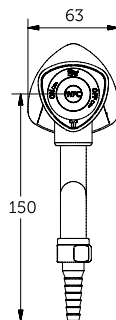

APPLICATION

Wall mounting

DETAILS

Waterflow around 17l/min
at 3 Bars pressure

Test pressure: 9 Bars/air

Max working pressure: 10 Bars

SURFACE PROTECTION

Epoxy powder coating
RAL 7035

MATERIALS

Brass

Handle in PP

HEADWORK SEALING

EPDM temperature
working range: 0-70°

CERAMIC temperature
working range: 0-70°

CONNECTION TAP

Male thread G1/2"

STANDARD AND NORMS

EN13792:2000

DIN12898

DIN12918

ISO228/1

OPTIONS

Joystick handle 11031.2MDSJ

Ceramic headwork 90°
11031.2MDSC

With chemical nickel
plating 17 microns inside
11031.2MDSNK

Spout:

150 - 200 - 250

300 - 350 mm

